



VIC PARK – ARMADALE/THORNLIE

**SHUTDOWN**

FROM 20 NOV '23



Transperth

## GETTING TO TAFE THORNLIE CAMPUS

The Armadale/Thornlie Line will close from Monday, 20 November 2023 until mid-2025 to facilitate major METRONET projects.

During the shutdown, trains will not operate between Victoria Park Station and Armadale Station. Passengers will no longer be able to alight trains at Gosnells, Thornlie or Maddington Stations to access Thornlie TAFE Campus services.

- **Routes 204 and 205** will continue to service Burslem Dr Thornlie TAFE (19144) and will undergo time changes.
- **Route 210** will continue to service Spencer Rd after Regal Dr (20496) and Corfield St after Burslem Dr (19069) and will undergo time changes.
- **Route 211** will continue to service Spencer Rd before Regal Dr (28263) and Spencer Rd after Warton Rd (20497) and will undergo time changes.
- **Route 228** will continue to service Burslem Dr before Baldwin St (19145) and will undergo time changes.

Refer to timetables on the Transperth website or at a Transperth InfoCentre for route information.

- **Timetable 1** – Route 204 and 205
- **Timetable 5** – Route 228
- **Timetable 11** – Route 210 and 211

Plan your journey at [transperth.wa.gov.au](https://transperth.wa.gov.au) and allow extra travel time.

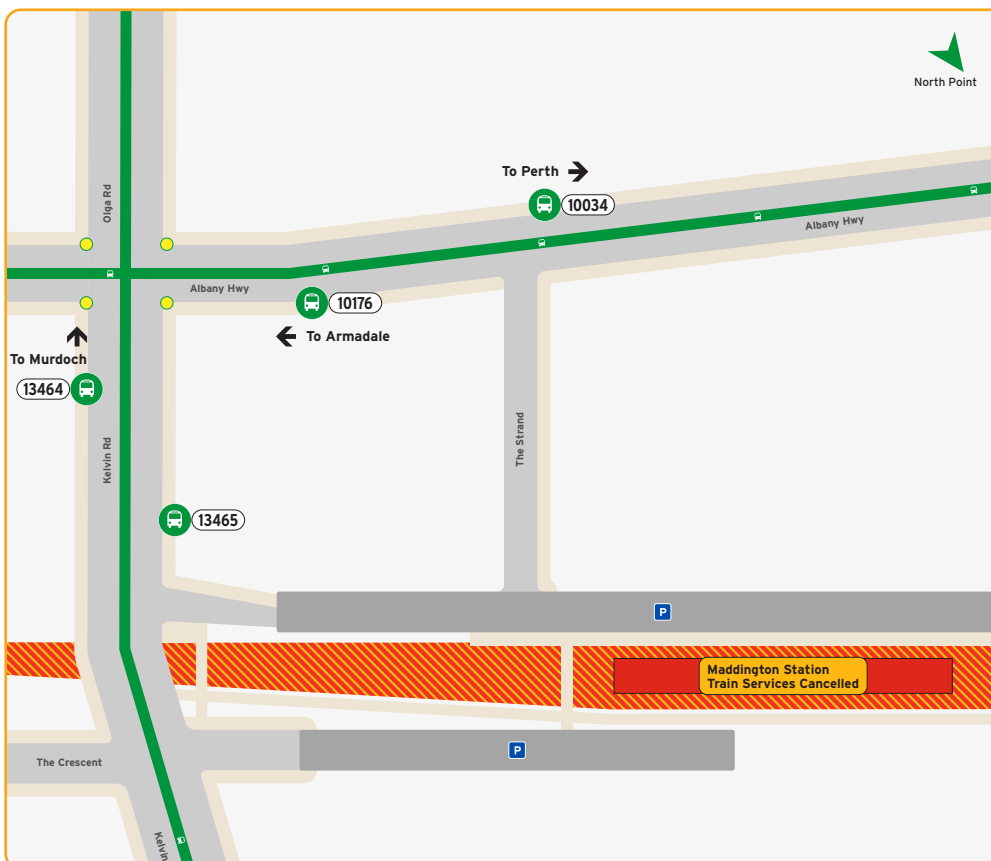

### Legend

- Bus Stop
- Train Line Closed
- Transperth Parking
- Bus Route
- Pedestrian Traffic Lights

### Station facilities

- 105 car bays
- 2 bus stops on Albany Hwy  
2 bus stops on Kelvin Rd
- Bike shelter

Pedestrian crossings near Maddington Station may close temporarily during the shutdown to allow for safe construction works. Please follow traffic management and signage.